

Hoist Bonding to Earth

Purpose

To avoid the risk of electric shock, all metal items within arm's reach of a bather (1.25 metres from the pool edge) must be electrically bonded to the main earthing system of the premises. This includes metal items including Pool Hoists.

The steel reinforcing of concrete pools and spas must also be electrically bonded to the earthing system

Electrical bonding must be carried out by a licensed electrical contractor. It is important you consult a licensed electrical contractor when the construction of a pool or spa is being considered. The electrical contractor will ideally be involved at the planning and design stage

Your licensed electrical contractor will consider:

- ✓ the power requirements to ensure safe operation of your pool or spa;
- ✓ if existing electrical equipment at your home needs to be relocated to fulfil safety requirements; and
- ✓ any other associated electrical requirements, such as outdoor lighting.

Note: Electrical bonding associated with a pool or spa must comply with Clause 5.6.2.6 of Australian Standard AS/NZS 3000:2018 (known as the 'Wiring Rules'). The electrical contractor will be responsible to ensure this compliance.

This is not advice, as professional advice must be sought by a qualified electrician

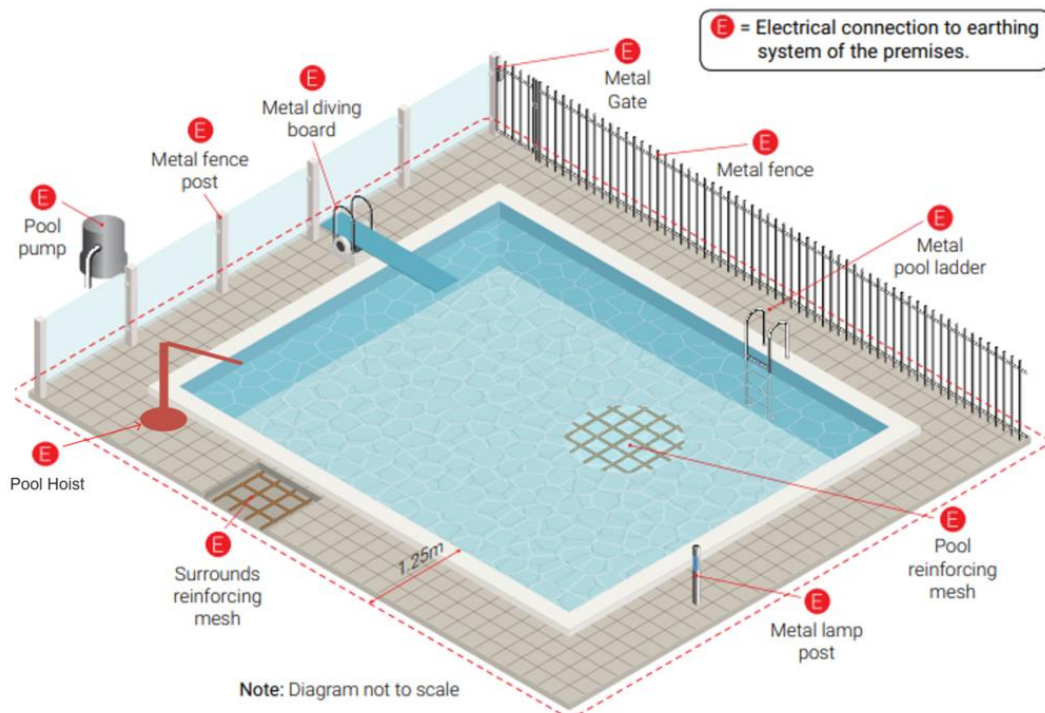

Para Mobility accepts no responsibility if this information is used. When undertaking any work, professional advice should be sought from suitably qualified persons in the field of work being undertaken

Pelican Pool Hoist – Bonding as per Option 1 for Mobile, or Option 2 for Fixed, as per the below install configuration and a Bonding ready kit is available, as per the Pelican below

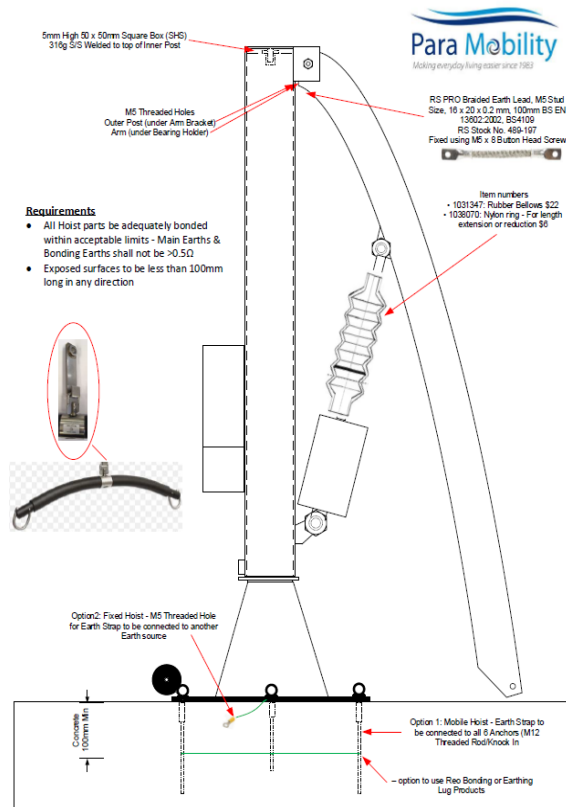

Kingfisher - Bonding as per Option 1 for Mobile, or Option 2 for Fixed, as per the below install configuration, (no additional items required)

